



## Rain Bird 7005/8005 Sod Cup Installation Guide



**Rain Bird Corporation**  
6991 E. Southpoint Road  
Tucson, AZ 85706 U.S.A.  
Phone: (520) 741-6100  
Fax: (520) 741-6522

**Rain Bird Corporation**  
970 West Sierra Madre Avenue  
Azusa, CA 91702 U.S.A.  
Phone: (626) 812-3400  
Fax: (626) 812-3411

**Rain Bird International, Inc.**  
P.O. Box 37  
Glendora, CA, 91740, U.S.A.  
Phone: (626) 963-9311  
Fax: (626) 852-7343

**Rain Bird Technical Services**  
(800) RAINBIRD (U.S. and Canada)

**Specification Hotline**  
800-458-3005 (U.S. and Canada)

[www.rainbird.com](http://www.rainbird.com)

## 7005/8005 Sod Cup Installation

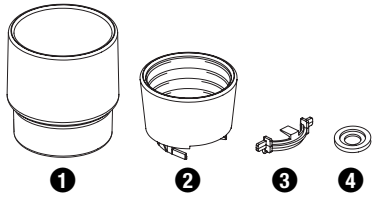

The sod cup is composed of four parts

- ❶ Outer Cup (Base)
- ❷ Inner Cup
- ❸ Clip Retainer
- ❹ Seal-A-Matic™ Seal

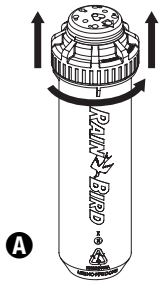

- ❶ To install, you must first unscrew the internal from the outer rotor case.

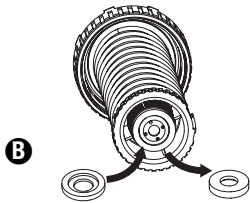

- ❷ Remove the existing Seal-A-Matic seal attached to the white plastic debris screen on the bottom of the internal riser. This can be done either by hand, with a screwdriver, or a pair of needle nose pliers. Attach the sod Seal-A-Matic seal onto the bottom of the white plastic piece as shown. Make sure that the chamfered cutout on the seal is facing outward.

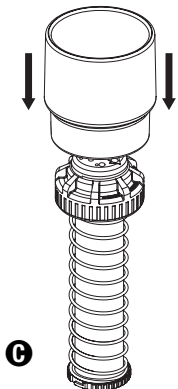

- ❸ Place the outer cup onto the top of the internal riser as shown. Push the outer cup downward firmly until resistance is felt or the bottom of the outer cup is in line with the bottom of the collar.

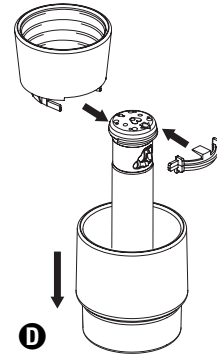

- ❹ Push the outer cup and collar downward onto a table until the rotor spring is fully compressed. **Use caution when compressing the spring to prevent the internal assembly from slipping and injuring the installer.** Insert the inner cup onto the top of the rubber cover as shown.

Install the retainer clip onto the inner cup as shown. The plastic wedge shaped piece in the middle should slide on top of the cap of the rotor. Make sure that both sides of the retainer clip are firmly secured.

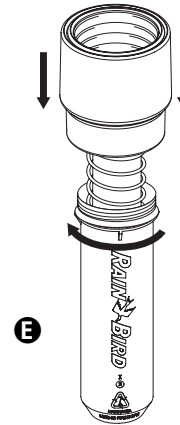

- ❺ Reassemble the internal rotor with the outer case. The Rain Bird Sod Cup can then be installed into the ground and filled with sod.

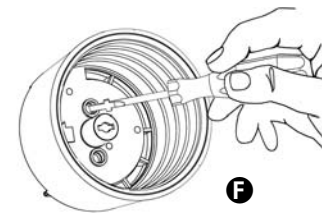

- ❻ Use the Arc Adjustment holes at the bottom of the inner cup to adjust the arc after the cup is installed on the rotor.

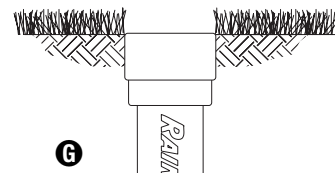

- ❼ Make sure that the top of the rubber sod cup is at grade, even with the existing ground.

**NOTE:** To remove sod cup you must first unscrew the internal from the outer rotor case. Then you must remove the inner cup by unlatching the retainer clip. Then you can take the outer cup off of the rotor collar.